

### LINPB-11RS-IN 封闭式精密直线轴承 Precision linear bearings, closed

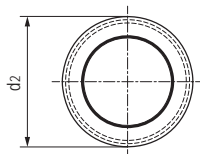

- 封闭式自动调心设计
- 高精度与滚珠轴承相同
- 标准滑动膜材料TEFPLAS<sup>®</sup> B
- 阳极氧化铝合金适配器
- 免维护、低噪音
- 使用温度 ± 200 °C
- Closed and self-aligning design
- High precision similar to preloaded ball bearing
- Standard liner material TEFPLAS<sup>®</sup> B
- Anodized aluminum adapter
- Maintenance-free and low noise
- Operation temperature ± 200 °C

### 标准规格 Standard specifications

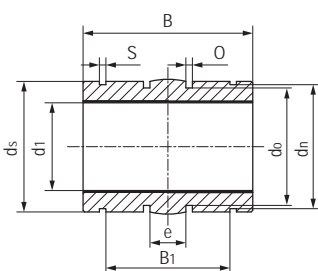

产品编码 Part No.:

LINPB-11RS-08-IN

- 英制 Inch size
- 内径 Inner diameter
- 自调整保持器 Automatic alignment aluminum adapter
- 长设计 Long design
- 滑动膜 Liner: TEFPLAS<sup>®</sup> B

座孔 Housing: H7 轴 Shaft: h6-h7

产品编码 Part No.	d <sub>1</sub> [Inch]		d <sub>2</sub> [Inch]		B [Inch]		d <sub>2</sub> [Inch]		B <sub>1</sub> [Inch]	d <sub>n</sub> [Inch]	S [Inch]	O [Inch]	d <sub>o</sub> [Inch]	e [Inch]
	Min.	Max.	Min.	Max.	Min.	Max.	Min.	Max.						
LINPB-11RS-04-IN	0.2502	0.0511	0.4990	0.5000	0.7350	0.7500	0.4975	0.4985	0.437	0.467	0.041	0.080	0.399	0.125
LINPB-11RS-06-IN	0.3752	0.3761	0.6240	0.6250	0.8600	0.8750	0.6225	0.6235	0.562	0.587	0.041	0.080	0.524	0.187
LINPB-11RS-08-IN	0.5002	0.5013	0.8740	0.8750	1.2350	1.2500	0.8725	0.8735	0.875	0.820	0.048	0.125	0.712	0.250
LINPB-11RS-10-IN	0.6252	0.6263	1.1240	1.1250	1.4850	1.5000	1.1225	1.1350	1.000	1.060	0.058	0.125	0.962	0.312
LINPB-11RS-12-IN	0.7503	0.7516	1.2490	1.2500	1.6100	1.6250	1.2475	1.2485	1.062	1.177	0.058	0.125	1.087	0.312
LINPB-11RS-16-IN	1.0003	1.0016	1.5613	1.5625	2.2350	2.2500	1.5599	1.5609	1.625	1.471	0.070	0.125	1.399	0.500
LINPB-11RS-20-IN	1.2504	1.2519	1.9988	2.0000	2.6100	2.6250	1.9974	1.9984	1.875	1.889	0.070	0.125	1.837	0.625
LINPB-11RS-24-IN	1.5004	1.5019	2.3738	2.3750	2.9850	3.0000	2.3724	2.3734	2.250	2.241	0.089	0.162	2.152	0.750

产品编码 Part No.	轴径 Shaft [Inch]	座孔 Housing [Inch]	F max. [N] 最大动载荷 Dynamic Load	F max. [N] 最大静载荷 Static Load	重量 Weight [g]
LINPB-11RS-04-IN	1/4	0.5000	1210	2420	4.3
LINPB-11RS-06-IN	3/8	0.6250	2082	4164	7.3
LINPB-11RS-08-IN	1/2	0.8750	3985	7971	18.6
LINPB-11RS-10-IN	5/8	1.1250	5990	11980	41.3
LINPB-11RS-12-IN	3/4	1.2500	7793	15587	49.4
LINPB-11RS-16-IN	1	1.5625	14424	28847	103.4
LINPB-11RS-20-IN	1-1/4	2.0000	21055	42110	208.2
LINPB-11RS-24-IN	1-1/2	2.3750	28895	57789	328.9